

The Great Grid Upgrade

Sea Link

Sea Link

Volume 2: Plans and Drawings

Document 2.5.1: Work Plans - Suffolk

Planning Inspectorate Reference: EN020026

**Version: B Version 2, change request
November 2025**

**Infrastructure Planning (Applications: Prescribed Forms and Procedure)
Regulations 2009 Regulation 5(2)(j)**

nationalgrid

Page intentionally left blank

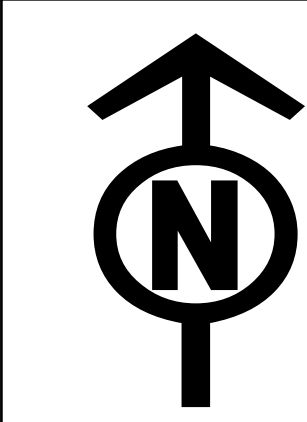

THE NATIONAL GRID (SEA LINK) ORDER
PINS APPLICATION NUMBER: EN020026
WORKS PLANS - SUFFOLK
REGULATION 5(2)(j)
KEY PLAN 1 OF 1
IN THE DISTRICT OF EAST SUFFOLK DISTRICT COUNCIL

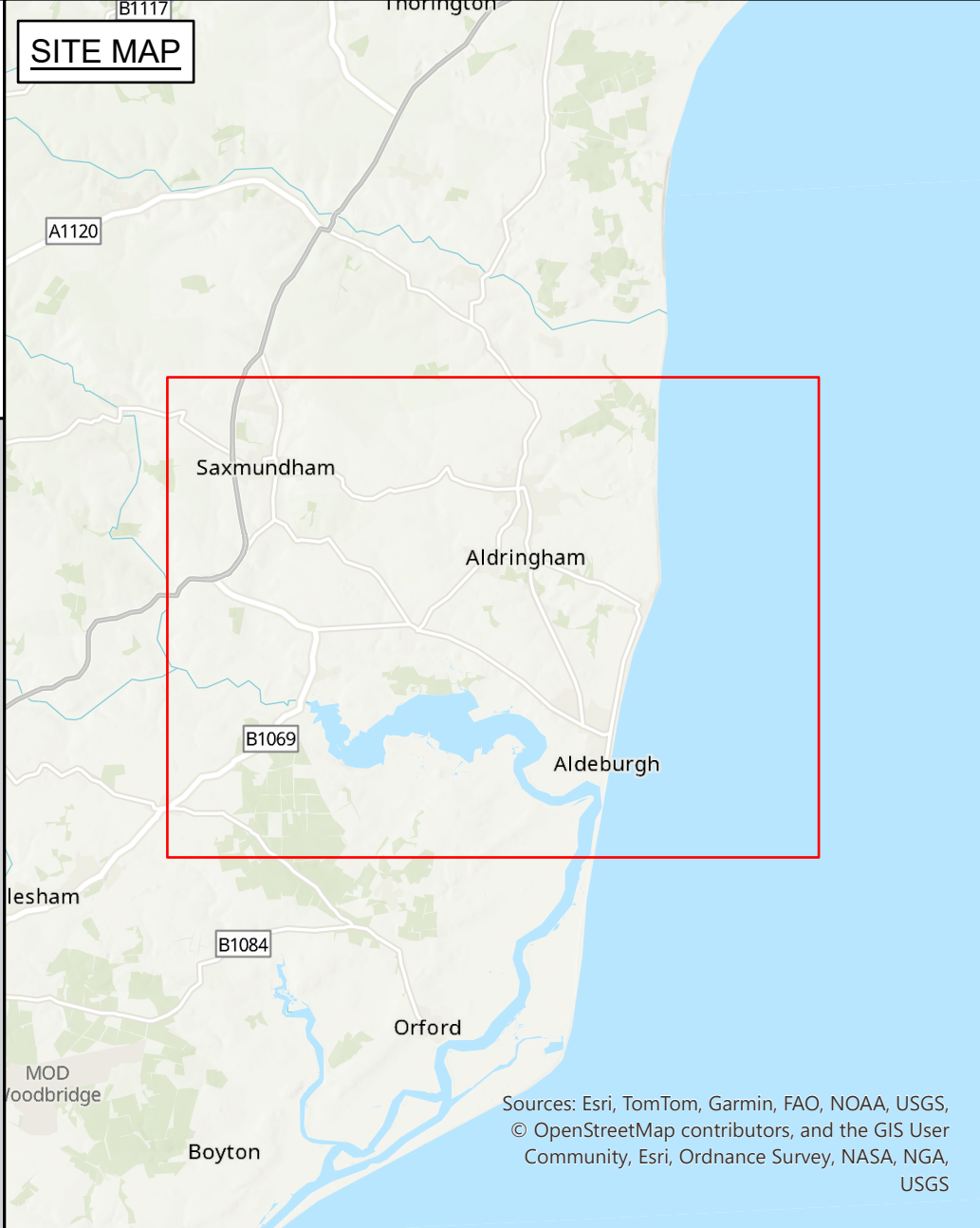
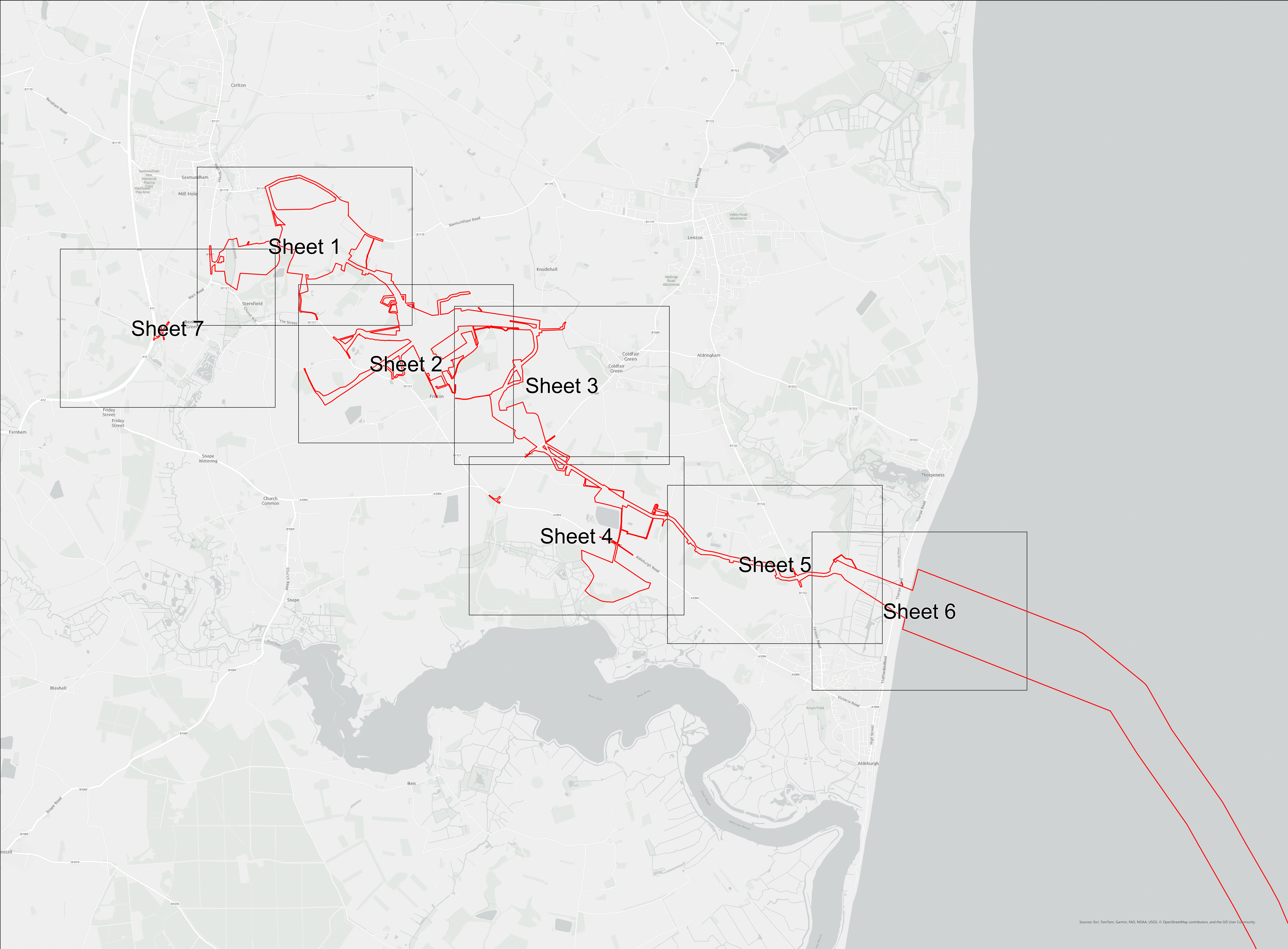

Application Document 2.5.1

Legend

Order Limits

Detailed sheet

Notes

1. This plan is scaled at paper size A0, therefore any prints taken at smaller sizes will affect accuracy of the measurement units and should not be scaled against.

2. For further information on construction please refer to the construction section of the Environmental Statement.

3. Reference should be made to the Guide to the Plans (Document Ref 2.1) which provides further information on what the plans show.

Coordinate System: British National Grid Sheet X Centroid Coordinate: N/A Sheet Y Centroid Coordinate: N/A

0 375 750 1,500 Metres

BACKGROUND MAPPING INFORMATION HAS BEEN REPRODUCED FROM THE ORDNANCE SURVEY BY PERMISSION OF ORDNANCE SURVEY OF THE CONTROLLER OF HIS MAJESTY'S STATIONERY OFFICE. CROWN COPYRIGHT ORDNANCE SURVEY 6 - 100024241. BLUESKY INTERNATIONAL LTD IS NATIONAL GRID ELECTRICITY. ESRI COMMUNITY MAPS CONTRIBUTORS, ESRI UK, ESRI, HERE, GARMIN, FOUR SQUARE, GEOTECHNOLOGIES, INC, METUNASA, USGS

A ver.2	Nov 25	Change request version	JF	SC	JW
A	06/03/25	For Submission	JF	SC	JW
Issue	Date	Remarks	Drawn	Checked	Approved

Title

THE NATIONAL GRID (SEA LINK) ORDER
PINS APPLICATION NUMBER: EN020026
WORKS PLANS - SUFFOLK
REGULATION 5(2)(j)
KEY PLAN 1 OF 1

nationalgrid

Application Number: EN020026

National Grid Drawing Reference: DCO/S/KP/SS/0400

Scale	Sheet Size	Sheet	Issue
1:15,000	A0	SHEET 1 OF 1	A ver.2

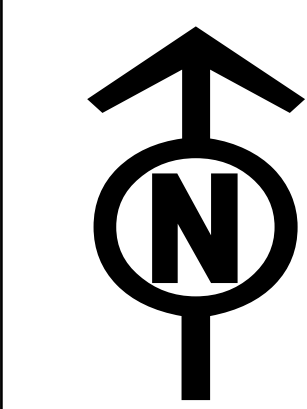

THE NATIONAL GRID (SEA LINK) ORDER
PINS APPLICATION NUMBER: EN020026
WORKS PLANS - SUFFOLK
REGULATION 5(2)(j)
SHEET 1 OF 7
IN THE DISTRICT OF EAST SUFFOLK DISTRICT COUNCIL

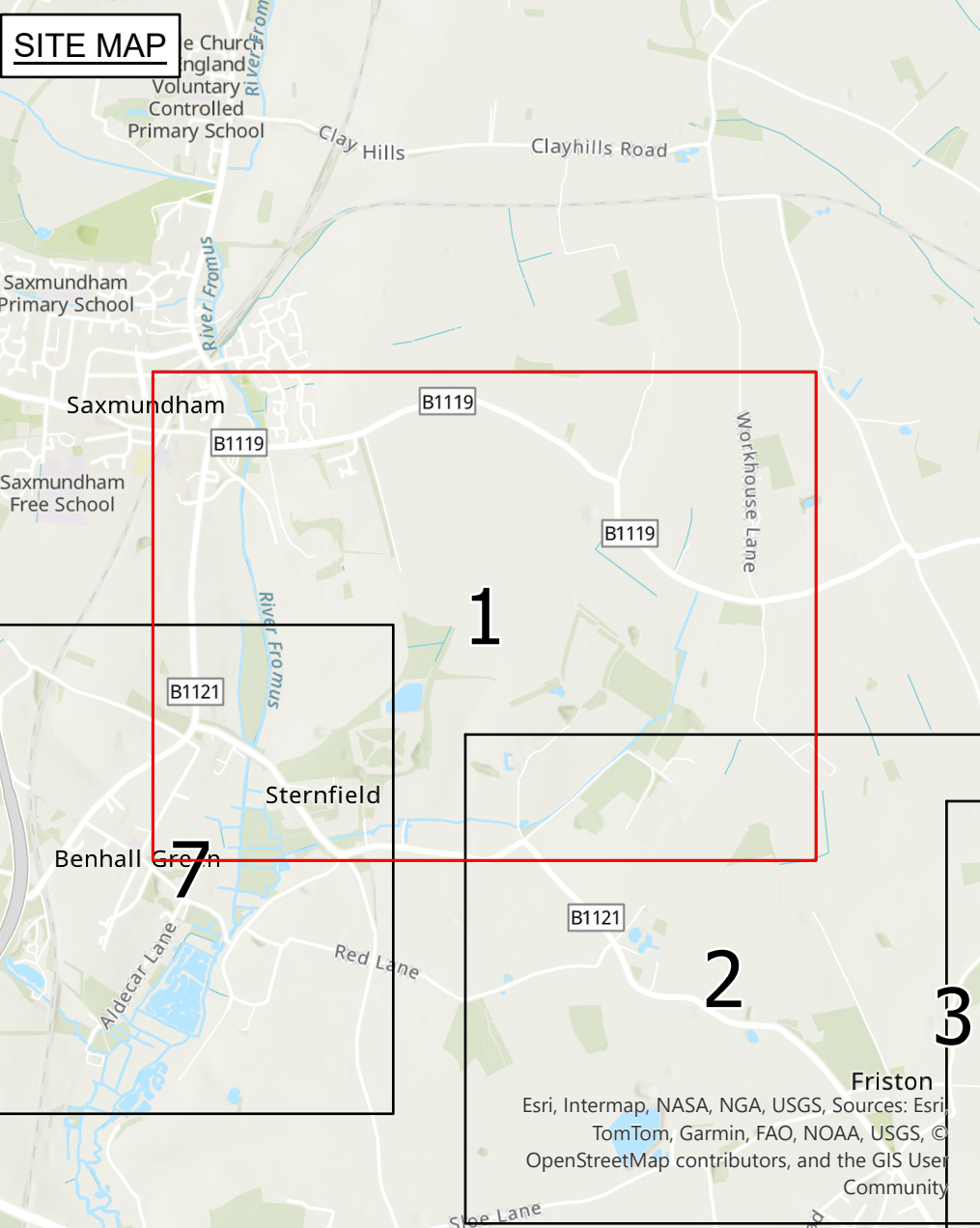
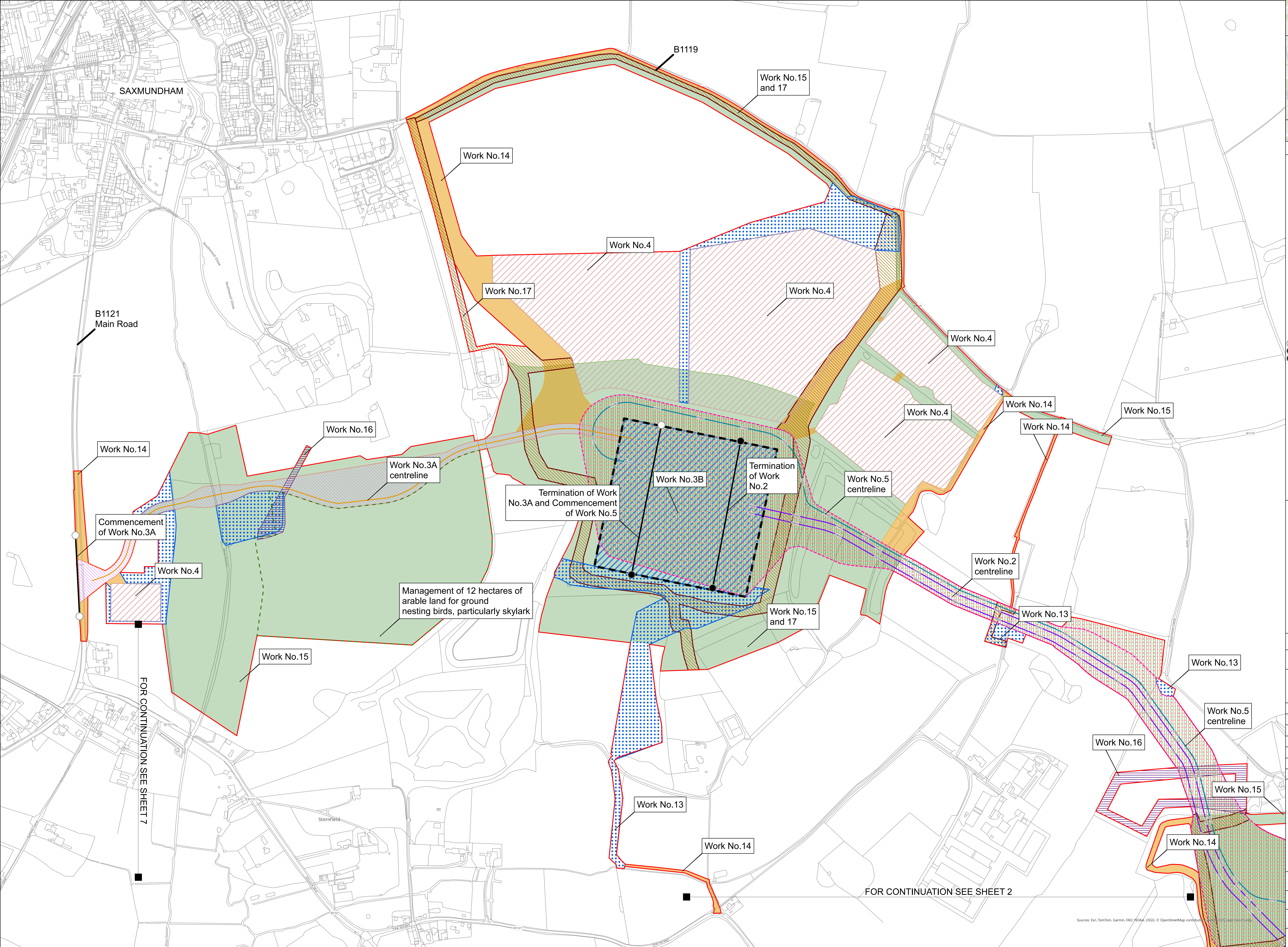

Application Document 2.5.1

- Legend**
- Order Limits
 - Limit of deviation: Access route
 - Limit of deviation: Non-linear works
 - Limit of deviation: Underground cables
 - Skylark mitigation area
 - Proposed High Voltage Direct Current (HVDC) cable alignment
 - Proposed High Voltage Alternating Current (HVAC) underground cables (see note 8)
 - Proposed access route centreline
 - Work No. 2 (incl. Work No. 13 and 14) - Proposed HVAC cables
 - Work No. 3A (incl. Work No. 13 and 14) - Proposed converter station access
 - Work No. 3B (incl. Work No. 13 and 14) - Proposed converter station
 - Work No. 4 (incl. Work No. 13 and 14) - Proposed temporary construction compound
 - Work No. 5 (incl. Work No. 13 and 14) - Proposed HVDC cables
 - Work No. 13 - Proposed principal drainage outside linear and non-linear limits of deviation
 - Work No. 14 - Proposed accesses for construction, monitoring and maintenance outside linear and non-linear limits of deviation
 - Work No. 15 - Proposed environmental mitigation and landscaping
 - Work No. 16 - Proposed utility diversions
 - Work No. 17 - Proposed public rights of way diversions
 - Commencement of work
 - Termination of work
 - Commencement and termination of work

- Notes**
- This plan is scaled at paper size A0, therefore any prints taken at smaller sizes will affect accuracy of the measurement units and should not be scaled against.
 - These plans show the Order Limits and potential locations for the works.
 - Due to the need for future flexibility, National Grid will be applying for Order Limits and Limits of Deviation within its Development Consent Order, within which any final alignment would lie.
 - For further information on construction please refer to the construction section of the Environmental Statement.
 - All areas within the Order Limits not identified as a Work No. are required for other elements of the authorised project as listed within Schedule 1.
 - Commencement and termination lines are shown for principal elements of linear works.
 - Due to the narrow nature of some of the accesses, when not printed to scale, they appear as a single red line on these drawings, these are in fact parallel lines following the access route.
 - Reference should be made to the Guide to the Plans (Document Ref 2.1) which provides further information on what the plans show.
 - The HVAC alignment is shown with two lines to represent the two trenches required for installation along the majority of the route.
 - Where the MHWS and MLWS coincide at the scale of the plans only the MHWS is shown.
 - For the avoidance of doubt, activities which are described both in Works 1-17 and in the associated development list in paragraph 2 of schedule 1 are not limited only to the areas shown within the areas indicated on the Works Plans for Works 1-17.

Coordinate System: British National Grid
Sheet X Centroid Coordinate: 639887.81 Sheet Y Centroid Coordinate: 262330.78



BACKGROUND MAPPING INFORMATION HAS BEEN REPRODUCED FROM THE ORDNANCE SURVEY BY PERMISSION OF ORDNANCE SURVEY OF THE CONTROLLER OF HIS MAJESTY'S STATIONERY OFFICE. CROWN COPYRIGHT ORDNANCE SURVEY 6 - 100024241. BLUESKY INTERNATIONAL LTD © NATIONAL GRID ELECTRICITY. ESRI COMMUNITY MAPS CONTRIBUTORS, ESRI UK, ESRI, HERE, GARMIN, FOUR SQUARE, GEOTECHNOLOGIES, INC, METANASA, USGS.

Title					
B ver.2	Nov 25	Change request version	JF	SC	JW
B	13/11/25	Work area updates	JF	SC	JW
A	06/03/25	For Submission	JF	SC	JW
Issue	Date	Remarks	Drawn	Checked	Approved

THE NATIONAL GRID (SEA LINK) ORDER
PINS APPLICATION NUMBER: EN020026
WORKS PLANS - SUFFOLK
REGULATION 5(2)(j)
SHEET 1 OF 7

nationalgrid			
Application Number			
EN020026			
National Grid Drawing Reference			
DCO/SWK/PS/0401			
Scale	Sheet Size	Sheet	Issue
1:2,500	A0	SHEET 1 OF 7	B ver.2

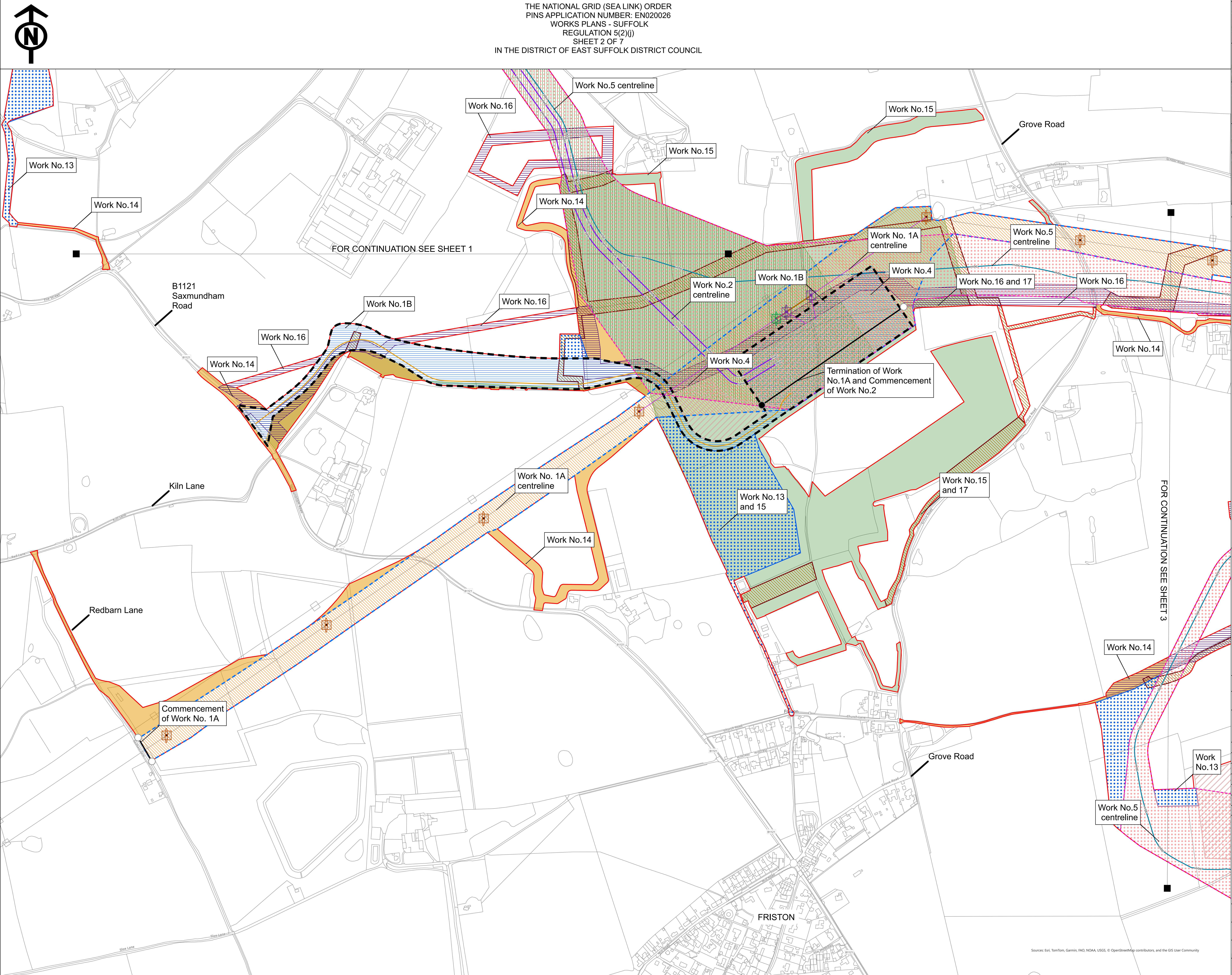

Legenda

- ## Notes
1. The plan is scaled at paper size A0, therefore any prints taken at smaller sizes will affect accuracy of the measurement units and should not be scaled against.
 2. These plans show the Order Limits and potential locations for the works. Drawings are not to be used for the purpose of determining Order Limits and Limits of Deviation within its Development Consent Order, within which any final alignment is to be determined.
 3. For further information on construction please refer to the construction section of the Environmental Statement.
 4. All areas within the Order Limits not identified as a Work No. are required for the works and are authorised property as listed within Schedule 1.
 5. Commencement and termination lines are shown for principal elements of linear works.
 6. To the narrow nature of some of the accesses, when not printed to scale, they appear as a single red line on these drawings, these are in fact parallel lines following the access route.
 7. Further details should be made to the Guide to the Plans (Document Ref 2.1) which provides further information on what the plans show.
 8. The HVAQ alignment is shown with two lines to represent the two trenches required for installation along the majority of the route.
 9. Where the MHWS and MLWS coincide at the scale of the plans only the MHWS is shown.
 10. To avoidance of doubt, activities which are described both in Plans 1-17 and in the associated development list in paragraph 2 of Schedule 1 are not limited only to the areas shown within the areas indicated on the Works Plans for Works 1-17.

B ver.2	Nov 25	Change request version	JF	SC	JW
B	13/11/25	Work area updates	JF	SC	JW
A	06/03/25	For Submission	JF	SC	JW
Issue	Date	Remarks	Drawn	Checked	Approved

Application Number

DCO/S/WK/PS/0402			
<u>Scale</u>	<u>Sheet Size</u>	<u>Sheet</u>	<u>Issue</u>

1:2,500	A0	SHEET 2 OF 7	B ver.2
---------	----	--------------	---------

COPYRIGHT: NOT TO BE REPRODUCED WITHOUT THE WRITTEN PERMISSION OF NATIONAL GRID ELECTRICITY TRANSMISSION Plc

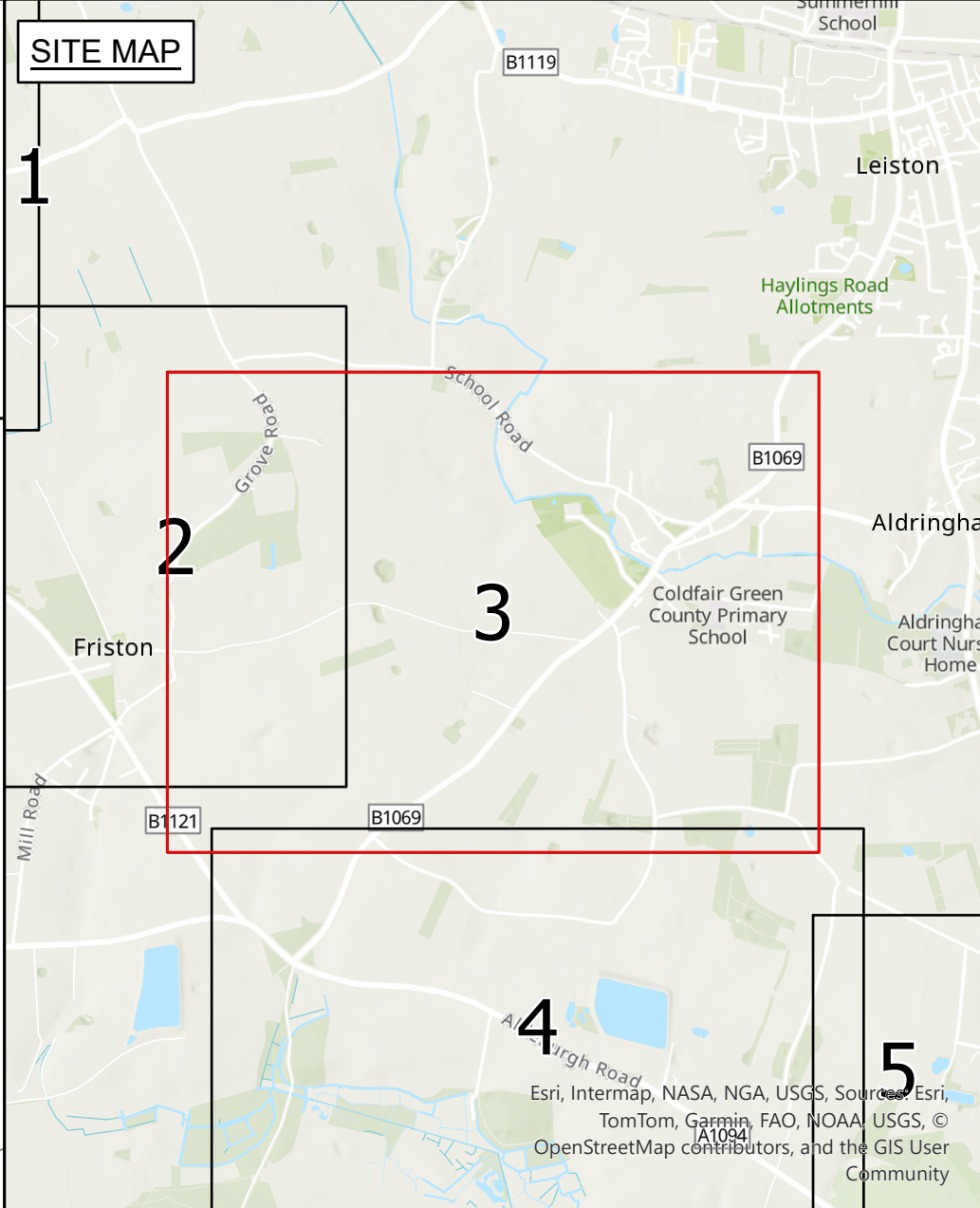
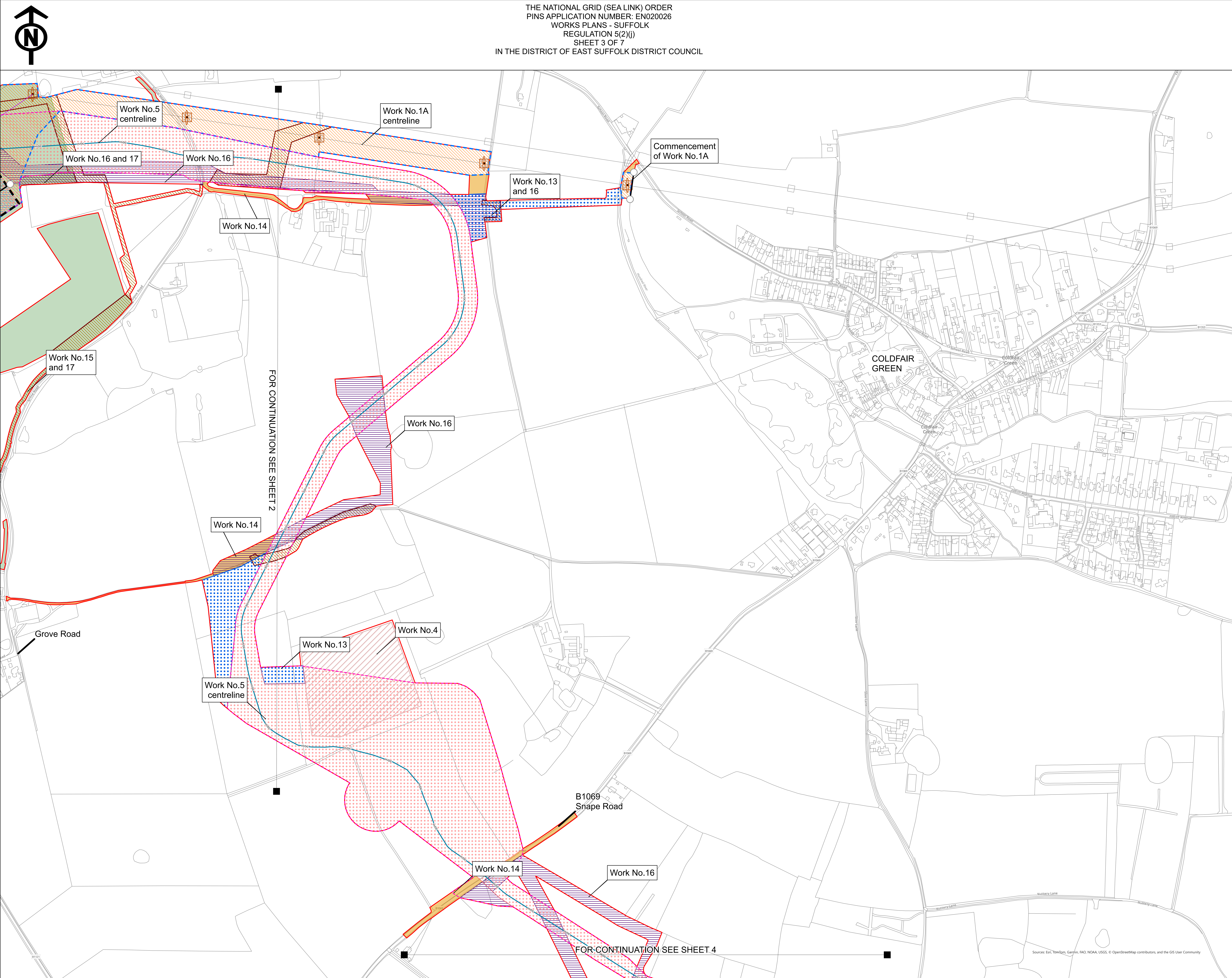

Application Document 2.5.1

- Legend**
- Order Limits
 - Limit of deviation: Non-linear works
 - Limit of deviation: Underground cables
 - Limit of deviation: Overhead lines
 - Proposed pylon modification works
 - Proposed High Voltage Direct Current (HVDC) cable alignment
 - Proposed 400kV overhead line
 - Work No.1A (incl. Work No.13 and 14) - Proposed overhead line works
 - Work No.1B (incl. Work No.13 and 14) - Proposed substation
 - Work No.4 (incl. Work No.13 and 14) - Proposed temporary construction compound
 - Work No.5 (incl. Work No.13 and 14) - Proposed HVDC cables
 - Work No.13 - Proposed principal drainage outside linear and non-linear limits of deviation
 - Work No.14 - Proposed accesses for construction, monitoring and maintenance outside linear and non-linear limits of deviation
 - Work No.15 - Proposed environmental mitigation and landscaping
 - Work No.16 - Proposed utility diversions
 - Work No.17 - Proposed public rights of way diversions
 - Commencement of work
 - Commencement and termination of work

- Notes**
- This plan is scaled at paper size A0, therefore any prints taken at smaller sizes will affect accuracy of the measurement units and should not be scaled against.
 - These plans show the Order Limits and potential locations for the works. Due to the need for future flexibility, National Grid will be applying for Order Limits and Limits of Deviation within its Development Consent Order, within which any final alignment would lie.
 - For further information on construction please refer to the construction section of the Environmental Statement.
 - All areas within the Order Limits not identified as a Work No. are required for other elements of the authorised project as listed within Schedule 1.
 - Commencement and termination lines are shown for principal elements of linear works.
 - Due to the narrow nature of some of the accesses, when not printed to scale, they appear as a single red line on these drawings, these are in fact parallel lines following the access route.
 - Reference should be made to the Guide to the Plans (Document Ref 2.1) which provides further information on what the plans show.
 - The HVAC alignment is shown with two lines to represent the two trenches required for installation along the majority of the route.
 - Where the MHWS and MLWS coincide at the scale of the plans only the MHWS is shown.
 - For the avoidance of doubt, activities which are described both in Works 1-17 and in the associated development list in paragraph 2 of schedule 1 are not limited only to the areas shown within the areas indicated on the Works Plans for Works 1-17.

Coordinate System: British National Grid
Sheet X Centroid Coordinate: 642755.44 Sheet Y Centroid Coordinate: 260670.66



BACKGROUND MAPPING INFORMATION HAS BEEN REPRODUCED FROM THE ORDNANCE SURVEY BY PERMISSION OF ORDNANCE SURVEY OF THE CONTROLLER OF HIS MAJESTY'S STATIONERY OFFICE. CROWN COPYRIGHT ORDNANCE SURVEY 6 - 100024241. BLUESKY INTERNATIONAL LTD IS: NATIONAL GRID ELECTRICITY. ESRI COMMUNITY MAPS CONTRIBUTORS, ESRI UK, ESRI, HERE, GARMIN, FOUR SQUARE, GEOTECHNOLOGIES, INC, METANASA, USGS

Issue	Date	Remarks	Drawn	Checked	Approved
B ver.2	Nov 25	Change request version	JF	SC	JW
B	13/11/25	Work area updates	JF	SC	JW
A	06/03/25	For Submission	JF	SC	JW

THE NATIONAL GRID (SEA LINK) ORDER
PINS APPLICATION NUMBER: EN020026
WORKS PLANS - SUFFOLK
REGULATION 5(2)(j)
SHEET 3 OF 7

nationalgrid			
Application Number			
EN020026			
National Grid Drawing Reference			
DCO/SWW/PS/0403			
Scale	Sheet Size	Sheet	Issue
1:2,500	A0	SHEET 3 OF 7	B ver.2

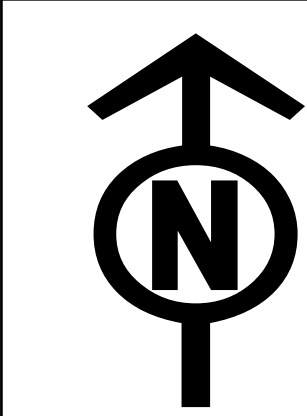

THE NATIONAL GRID (SEA LINK) ORDER
PINS APPLICATION NUMBER: EN020026
WORKS PLANS - SUFFOLK
REGULATION 5(2)(j)
SHEET 4 OF 7
IN THE DISTRICT OF EAST SUFFOLK DISTRICT COUNCIL

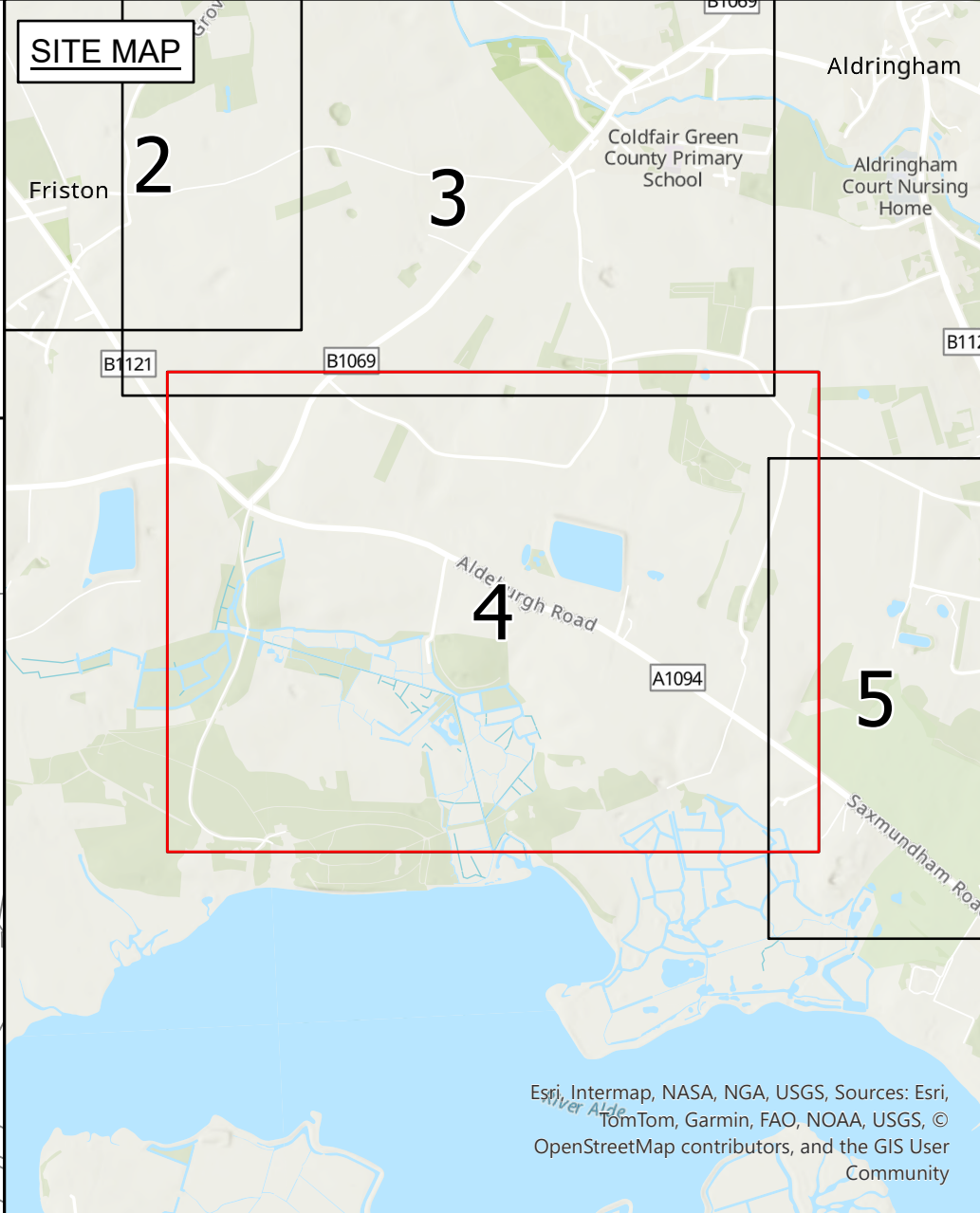
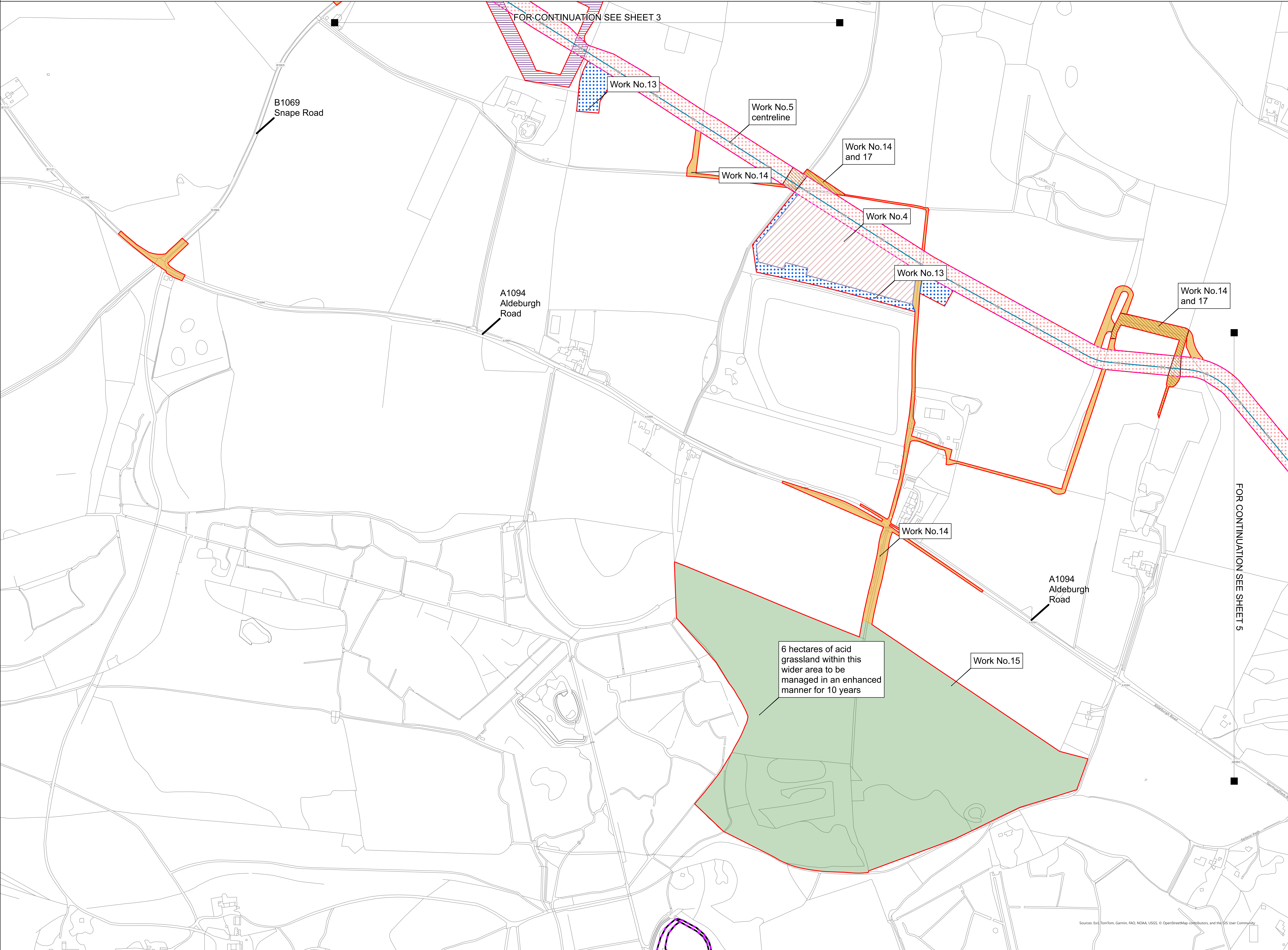

Application Document 2.5.1

- Legend**
- Order Limits
 - Limit of deviation: Underground cables
 - Proposed High Voltage Direct Current (HVDC) cable alignment
 - Work No.4 (incl. Work No.13 and 14) - Proposed temporary construction compound
 - Work No.5 (incl. Work No.13 and 14) - Proposed HVDC cables
 - Work No.13 - Proposed principal drainage outside linear and non-linear limits of deviation
 - Work No.14 - Proposed accesses for construction, monitoring and maintenance outside linear and non-linear limits of deviation
 - Work No.15 - Proposed environmental mitigation and landscaping
 - Work No.16 - Proposed utility diversions
 - Work No.17 - Proposed public rights of way diversions
 - Mean High Water Spring

- Notes**
- This plan is scaled at paper size A0, therefore any prints taken at smaller sizes will affect accuracy of the measurement units and should not be scaled against.
 - These plans show the Order Limits and potential locations for the works.
 - Due to the need for future flexibility, National Grid will be applying for Order Limits and Limits of Deviation within its Development Consent Order, within which any final alignment would lie.
 - For further information on construction please refer to the construction section of the Environmental Statement.
 - All areas within the Order Limits not identified as a Work No. are required for other elements of the authorised project as listed within Schedule 1.
 - Commencement and termination lines are shown for principal elements of linear works.
 - Due to the narrow nature of some of the accesses, when not printed to scale, they appear as a single red line on these drawings, these are in fact parallel lines following the access route.
 - Reference should be made to the Guide to the Plans (Document Ref 2.1) which provides further information on what the plans show.
 - The HVAC alignment is shown with two lines to represent the two trenches required for installation along the majority of the route.
 - Where the MHWS and MLWS coincide at the scale of the plans only the MHWS is shown.
 - For the avoidance of doubt, activities which are described both in Works 1-17 and in the associated development list in paragraph 2 of schedule 1 are not limited only to the areas shown within the areas indicated on the Works Plans for Works 1-17.

Coordinate System: British National Grid
Sheet X Centroid Coordinate: 642931 Sheet Y Centroid Coordinate: 258875 42



BACKGROUND MAPPING INFORMATION HAS BEEN REPRODUCED FROM THE ORDNANCE SURVEY BY PERMISSION OF ORDNANCE SURVEY OF THE CONTROLLER OF HIS MAJESTY'S STATIONERY OFFICE. CROWN COPYRIGHT ORDNANCE SURVEY 6 - 100024241. BLUESKY INTERNATIONAL LTD © NATIONAL GRID ELECTRICITY. ESRI COMMUNITY MAPS CONTRIBUTORS, ESRI UK, ESRI, HERE, GARMIN, FOUR SQUARE, GEOTECHNOLOGIES, INC, METIUNASA, USGS

B ver.2	Nov 25	Change request version	JF	SC	JW
B	13/11/25	Work area updates	JF	SC	JW
A	06/03/25	For Submission	JF	SC	JW
Issue	Date	Remarks	Drawn	Checked	Approved
Title					

THE NATIONAL GRID (SEA LINK) ORDER
PINS APPLICATION NUMBER: EN020026
WORKS PLANS - SUFFOLK
REGULATION 5(2)(j)
SHEET 4 OF 7

nationalgrid

Application Number
EN020026

National Grid Drawing Reference
DCO/SWW/PS/0404

Scale	Sheet Size	Sheet	Issue
1:2,500	A0	SHEET 4 OF 7	B ver.2

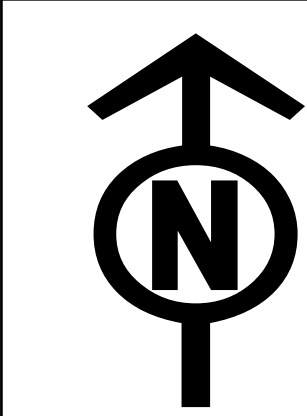

THE NATIONAL GRID (SEA LINK) ORDER
PINS APPLICATION NUMBER: EN020026
WORKS PLANS - SUFFOLK
REGULATION 5(2)(j)
SHEET 5 OF 7
IN THE DISTRICT OF EAST SUFFOLK DISTRICT COUNCIL

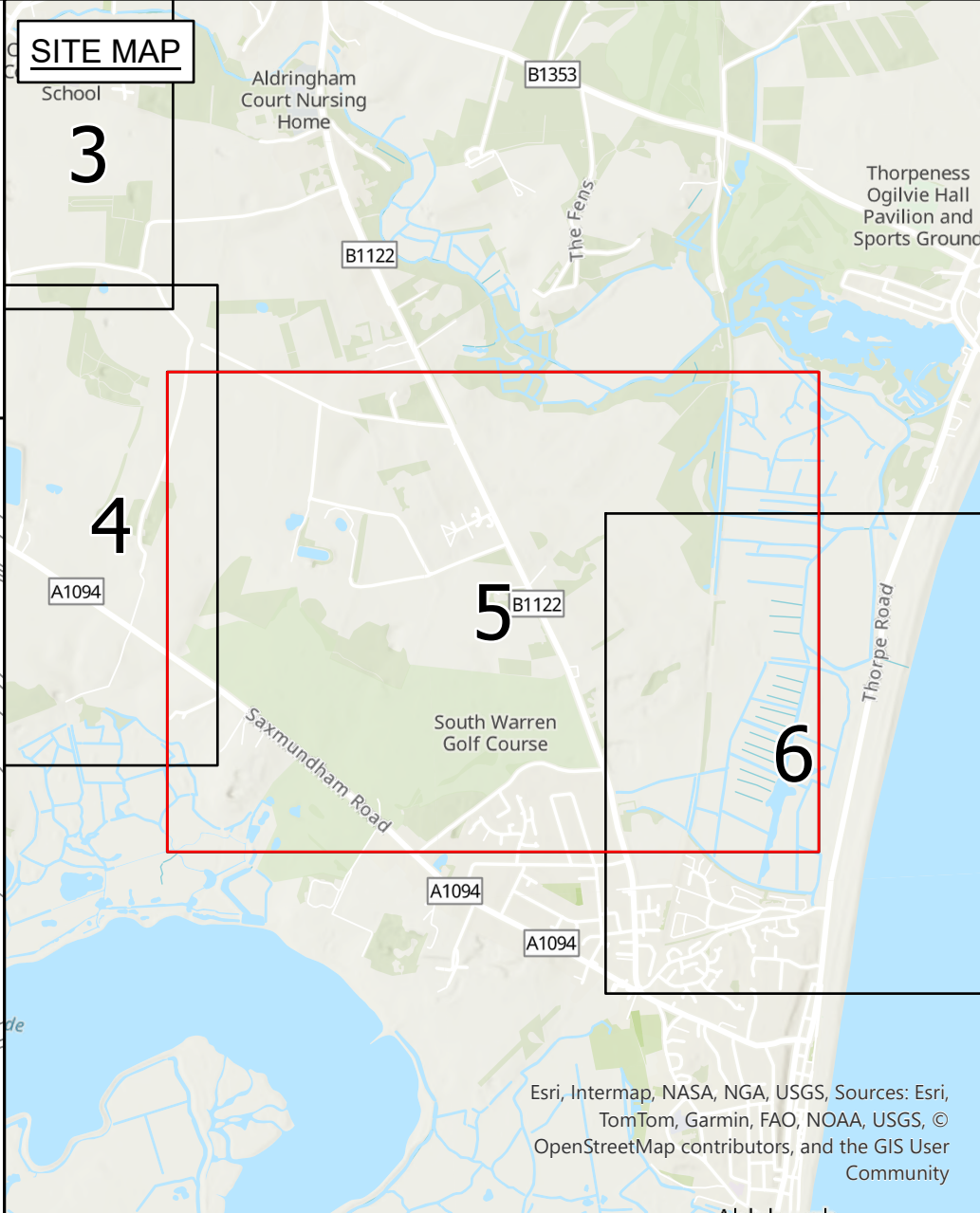
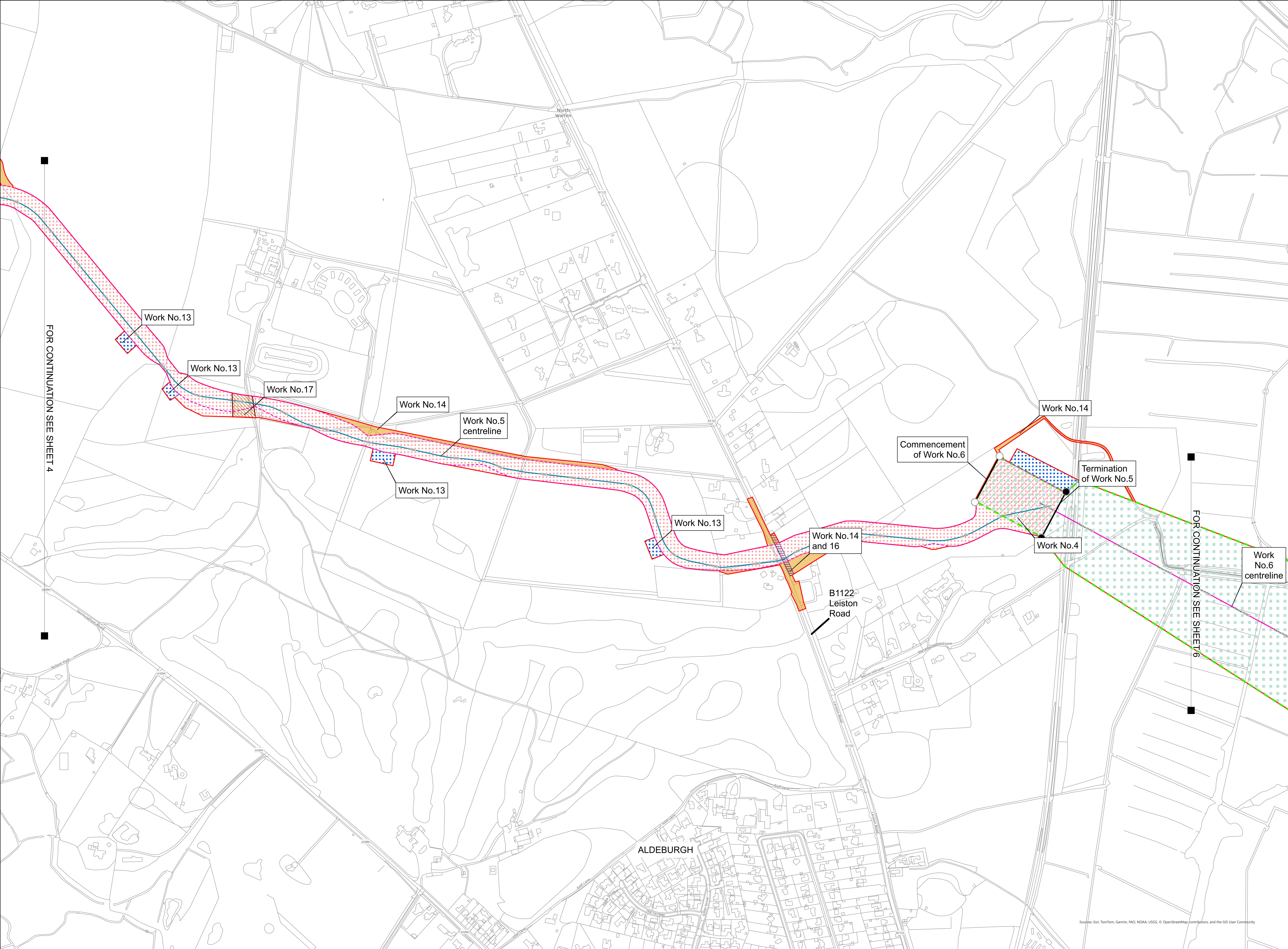

Application Document 2.5.1

- Legend**
- Order Limits
 - Limit of deviation: Underground cables
 - Limit of deviation: High Voltage Direct Current (HVDC) marine cables
 - Proposed High Voltage Direct Current (HVDC) cable alignment
 - Proposed marine High Voltage Direct Current (HVDC) cable alignment
 - Work No. 4 (incl. Work No. 13 and 14) - Proposed temporary construction compound
 - Work No. 5 (incl. Work No. 13 and 14) - Proposed HVDC cables
 - Work No. 6 (incl. Work No. 14) - Proposed marine HVDC cables
 - Work No. 13 - Proposed principal drainage outside linear and non-linear limits of deviation
 - Work No. 14 - Proposed accesses for construction, monitoring and maintenance outside linear and non-linear limits of deviation
 - Work No. 16 - Proposed utility diversions
 - Work No. 17 - Proposed public rights of way diversions
 - Commencement of work
 - Termination of work

- Notes**
- This plan is scaled at paper size A0, therefore any prints taken at smaller sizes will affect accuracy of the measurement units and should not be scaled against.
 - These plans show the Order Limits and potential locations for the works. Due to the need for future flexibility, National Grid will be applying for Order Limits and Limits of Deviation within its Development Consent Order, within which any final alignment would lie.
 - For further information on construction please refer to the construction section of the Environmental Statement.
 - All areas within the Order Limits not identified as a Work No. are required for other elements of the authorised project as listed within Schedule 1.
 - Commencement and termination lines are shown for principal elements of linear works.
 - Due to the narrow nature of some of the accesses, when not printed to scale, they appear as a single red line on these drawings, these are in fact parallel lines following the access route.
 - Reference should be made to the Guide to the Plans (Document Ref 2.1) which provides further information on what the plans show.
 - The HVAC alignment is shown with two lines to represent the two trenches required for installation along the majority of the route.
 - Where the MHWS and MLWS coincide at the scale of the plans only the MHWS is shown.
 - For the avoidance of doubt, activities which are described both in Works 1-17 and in the associated development list in paragraph 2 of schedule 1 are not limited only to the areas shown within the areas indicated on the Works Plans for Works 1-17.

Coordinate System: British National Grid
Sheet X Centroid Coordinate: 645296.31 Sheet Y Centroid Coordinate: 258534.94



BACKGROUND MAPPING INFORMATION HAS BEEN REPRODUCED FROM THE ORDNANCE SURVEY BY PERMISSION OF ORDNANCE SURVEY OF THE CONTROLLER OF HIS MAJESTY'S STATIONERY OFFICE. CROWN COPYRIGHT ORDNANCE SURVEY © 10002421. BLUESKY INTERNATIONAL LTD © NATIONAL GRID ELECTRICITY. ESRI COMMUNITY MAPS CONTRIBUTORS, ESRI UK, ESRI, HERE, GARMIN, FOUR SQUARE, GEOTECHNOLOGIES, INC, METIUNASA, USGS

Issue	Date	Remarks	Drawn	Checked	Approved
B ver.2	Nov 25	Change request version	JF	SC	JW
B	13/11/25	Work area updates	JF	SC	JW
A	06/03/25	For Submission	JF	SC	JW

Title

THE NATIONAL GRID (SEA LINK) ORDER
PINS APPLICATION NUMBER: EN020026
WORKS PLANS - SUFFOLK
REGULATIONS 5(2)(j)
SHEET 5 OF 7

nationalgrid

Application Number
EN020026

National Grid Drawing Reference
DCO/SWK/PS/0405

Scale	Sheet Size	Sheet	Issue
1:2,500	A0	SHEET 5 OF 7	B ver.2

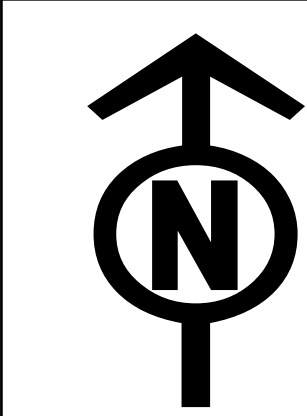

THE NATIONAL GRID (SEA LINK) ORDER
PINS APPLICATION NUMBER: EN020026
WORKS PLANS - SUFFOLK
REGULATION 5(2)(j)
SHEET 6 OF 7
IN THE DISTRICT OF EAST SUFFOLK DISTRICT COUNCIL

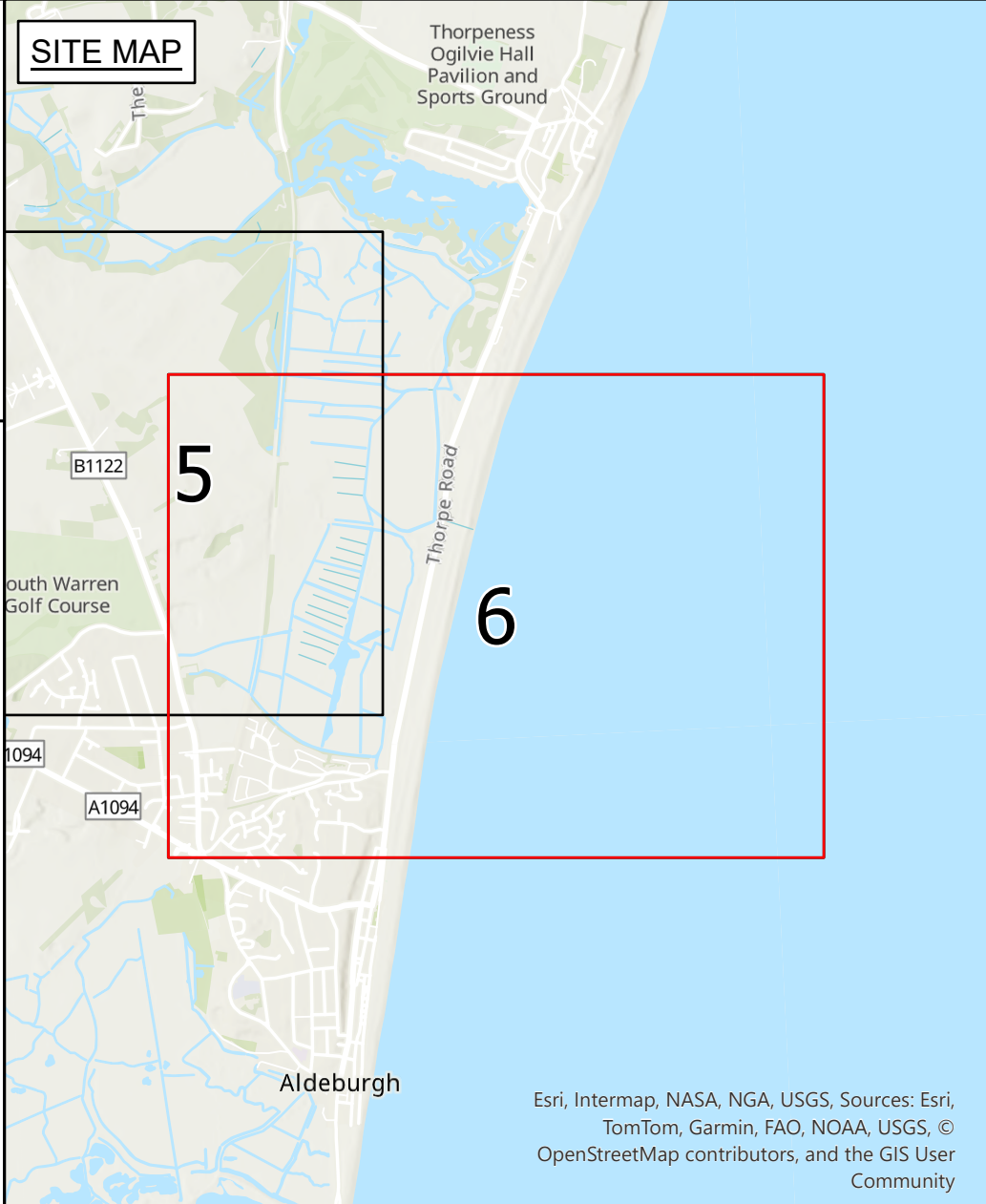
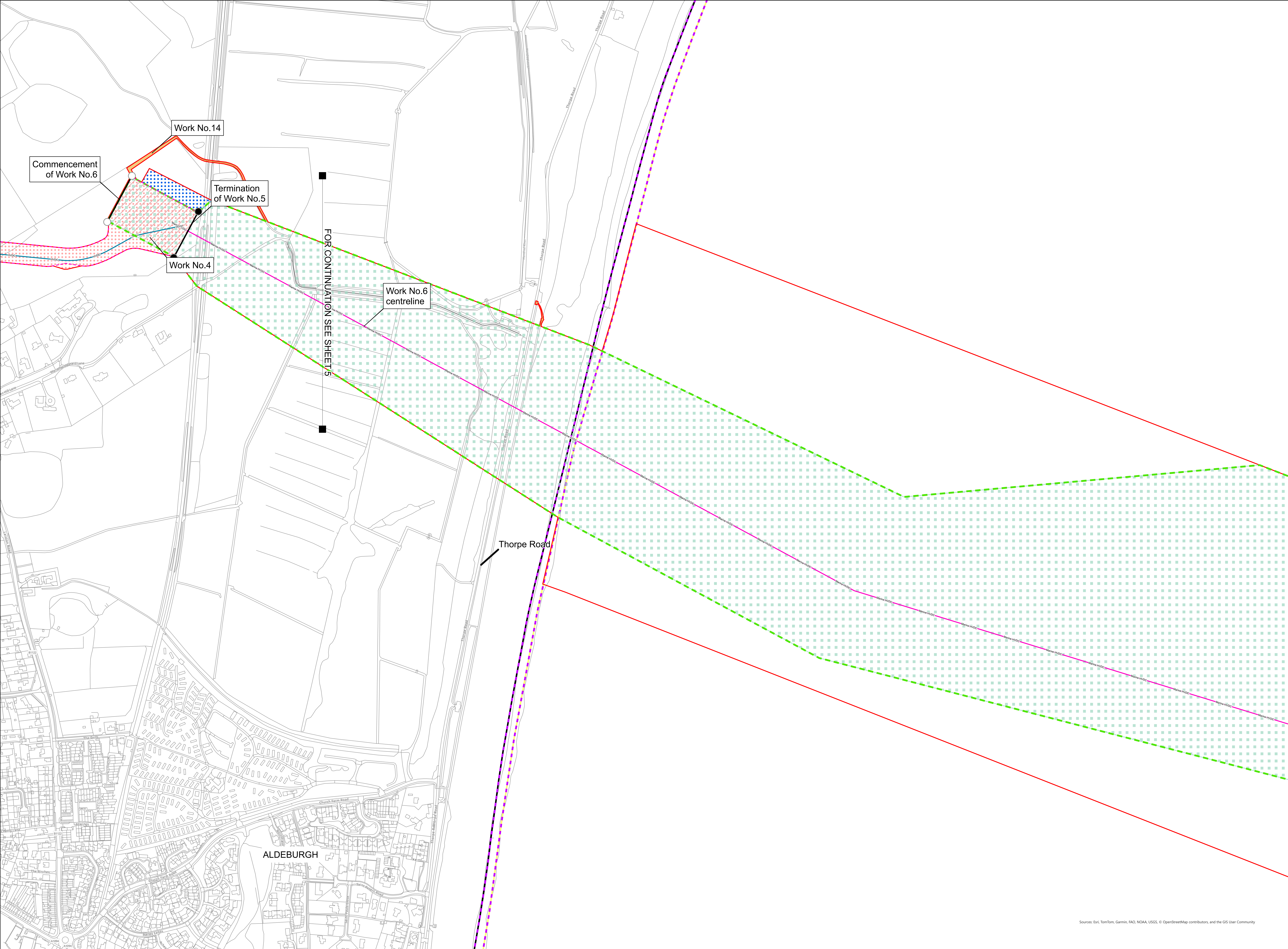

Application Document 2.5.1

- Legend**
- Order Limits
 - Limit of deviation: Underground cables
 - Limit of deviation: High Voltage Direct Current (HVDC) marine cables
 - Proposed High Voltage Direct Current (HVDC) cable alignment
 - Proposed marine High Voltage Direct Current (HVDC) cable alignment
 - Work No. 4 (incl. Work No. 13 and 14) - Proposed temporary construction compound
 - Work No. 5 (incl. Work No. 13 and 14) - Proposed HVDC cables
 - Work No. 6 (incl. Work No. 14) - Proposed marine HVDC cables
 - Work No. 13 - Proposed principal drainage outside linear and non-linear limits of deviation
 - Work No. 14 - Proposed accesses for construction, monitoring and maintenance outside linear and non-linear limits of deviation
 - Mean High Water Spring
 - Mean Low Water Spring
 - Commencement of work
 - Termination of work

- Notes**
- This plan is scaled at paper size A0, therefore any prints taken at smaller sizes will affect accuracy of the measurement units and should not be scaled against.
 - These plans show the Order Limits and potential locations for the works.
 - Due to the need for future flexibility, National Grid will be applying for Order Limits and Limits of Deviation within its Development Consent Order, within which any final alignment would lie.
 - For further information on construction please refer to the construction section of the Environmental Statement.
 - All areas within the Order Limits not identified as a Work No. are required for other elements of the authorised project as listed within Schedule 1.
 - Commencement and termination lines are shown for principal elements of linear works.
 - Due to the narrow nature of some of the accesses, when not printed to scale, they appear as a single red line on these drawings, these are in fact parallel lines following the access route.
 - Reference should be made to the Guide to the Plans (Document Ref 2.1) which provides further information on what the plans show.
 - The HVAC alignment is shown with two lines to represent the two trenches required for installation along the majority of the route.
 - Where the MHS and MLWS coincide at the scale of the plans only the MHS is shown.
 - For the avoidance of doubt, activities which are described both in Works 1-17 and in the associated development list in paragraph 2 of schedule 1 are not limited only to the areas shown within the areas indicated on the Works Plans for Works 1-17.

Coordinate System: British National Grid
Sheet X Centroid Coordinate: 647021.19 Sheet Y Centroid Coordinate: 257977.8



BACKGROUND MAPPING INFORMATION HAS BEEN REPRODUCED FROM THE ORDNANCE SURVEY BY PERMISSION OF ORDNANCE SURVEY OF THE CONTROLLER OF HIS MAJESTY'S STATIONERY OFFICE. CROWN COPYRIGHT ORDNANCE SURVEY 6 - 100024241. BLUESKY INTERNATIONAL LTD © NATIONAL GRID ELECTRICITY. ESRI COMMUNITY MAPS CONTRIBUTORS, ESRI UK, ESRI, HERE, GARMIN, FOUR SQUARE, GEOTECHNOLOGIES, INC, METI/MASA, USGS

Issue	Date	Remarks	Drawn	Checked	Approved
B ver.2	Nov 25	Change request version	JF	SC	JW
B	13/11/25	Work area updates	JF	SC	JW
A	06/03/25	For Submission	JF	SC	JW

THE NATIONAL GRID (SEA LINK) ORDER
PINS APPLICATION NUMBER: EN020026
WORKS PLANS - SUFFOLK
REGULATION 5(2)(j)
SHEET 6 OF 7

nationalgrid			
Application Number			
EN020026			
National Grid Drawing Reference			
DCO/SWK/PS/0406			
Scale	Sheet Size	Sheet	Issue
1:2,500	A0	SHEET 6 OF 7	B ver.2

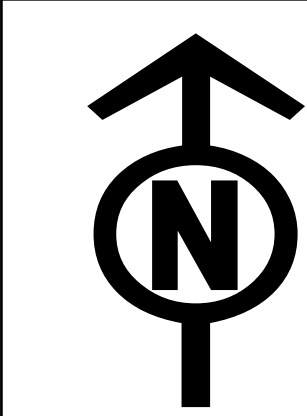

THE NATIONAL GRID (SEA LINK) ORDER
PINS APPLICATION NUMBER: EN020026
WORKS PLANS - SUFFOLK
REGULATION 5(2)(j)
SHEET 7 OF 7
IN THE DISTRICT OF EAST SUFFOLK DISTRICT COUNCIL

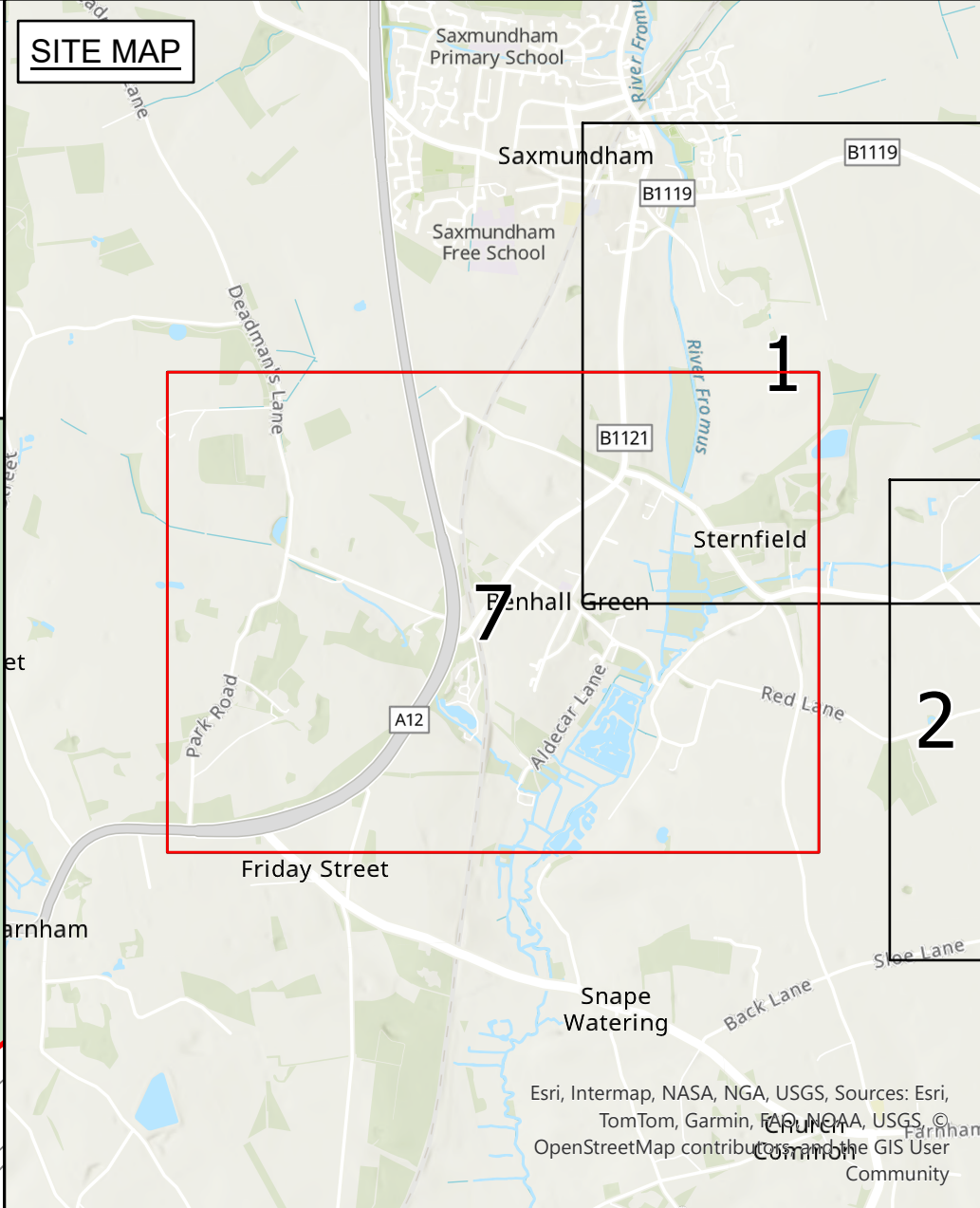

Application Document 2.5.1

- Legend**
- Order Limits
 - Limit of deviation: Access route
 - Skylark mitigation area
 - Proposed access route centreline
 - Work No.3A (incl. Work No.13 and 14) - Proposed converter station access
 - Work No.4 (incl. Work No.13 and 14) - Proposed temporary construction compound
 - Work No.13 - Proposed principal drainage outside linear and non-linear limits of deviation
 - Work No.14 - Proposed accesses for construction, monitoring and maintenance outside linear and non-linear limits of deviation
 - Work No.15 - Proposed environmental mitigation and landscaping
 - Work No.16 - Proposed utility diversions
 - Commencement of work

- Notes**
- This plan is scaled at paper size A0, therefore any prints taken at smaller sizes will affect accuracy of the measurement units and should not be scaled against.
 - These plans show the Order Limits and potential locations for the works. Due to the need for future flexibility, National Grid will be applying for Order Limits and Limits of Deviation within its Development Consent Order, within which any final alignment would lie.
 - For further information on construction please refer to the construction section of the Environmental Statement.
 - All areas within the Order Limits not identified as a Work No. are required for other elements of the authorised project as listed within Schedule 1.
 - Commencement and termination lines are shown for principal elements of linear works.
 - Due to the narrow nature of some of the accesses, when not printed to scale, they appear as a single red line on these drawings, these are in fact parallel lines following the access route.
 - Reference should be made to the Guide to the Plans (Document Ref 2.1) which provides further information on what the plans show.
 - The HVAC alignment is shown with two lines to represent the two trenches required for installation along the majority of the route.
 - Where the MHWS and MLWS coincide at the scale of the plans only the MHWS is shown.
 - For the avoidance of doubt, activities which are described both in Works 1-17 and in the associated development list in paragraph 2 of schedule 1 are not limited only to the areas shown within the areas indicated on the Works Plans for Works 1-17.

Coordinate System: British National Grid
Sheet X Centroid Coordinate: 638954.19 Sheet Y Centroid Coordinate: 261352.39



BACKGROUND MAPPING INFORMATION HAS BEEN REPRODUCED FROM THE ORDNANCE SURVEY BY PERMISSION OF ORDNANCE SURVEY OF THE CONTROLLER OF HIS MAJESTY'S STATIONERY OFFICE. CROWN COPYRIGHT ORDNANCE SURVEY 6 - 100024241. BLUESKY INTERNATIONAL LTD IS NATIONAL GRID ELECTRICITY. ESRI COMMUNITY MAPS CONTRIBUTORS, ESRI UK, ESRI, HERE, GARMIN, FOUR SQUARE, GEOTECHNOLOGIES, INC, METIUNASA, USGS

B ver.2	Nov 25	Change request version	JF	SC	JW
B	13/11/25	Work area updates	JF	SC	JW
A	06/03/25	For Submission	JF	SC	JW
Issue	Date	Remarks	Drawn	Checked	Approved
Title					

THE NATIONAL GRID (SEA LINK) ORDER
PINS APPLICATION NUMBER: EN020026
WORKS PLANS - SUFFOLK
REGULATION 5(2)(j)
SHEET 7 OF 7



Application Number: EN020026

National Grid Drawing Reference: DCO/SWK/PS/0418

Scale	Sheet Size	Sheet	Issue
1:2,500	A0	SHEET 7 OF 7	B ver.2